



**Perth, WA**  
16/315 Bulwer Street

**1** BED  
**1** BATH  
**0** CAR

**paragon**  
PROPERTY

**BRILLIANT BULWER - Enter H/O from Fitzgerald Street**

You will love coming home to this beautifully appointed 2 level townhouse, nestled amongst a boutique complex which will suit the astute investor or an ideal starter for singles and couples. Enjoy magnificent city views from the master bedroom and living, also enjoy relaxing after work in your very own private south facing courtyard. Located on the city doorstep where you can leisurely stroll your way to Hyde Park, Robertson Park Tennis Club, with public transport at your doorstep.

Some highlights of this fabulous apartment include -

- Generous 58 sqm of internal living space
- Open plan kitchen/meals and living area
- Magnificent city views from the master bedroom and living area

**\$369,000**

**Council Rates:** \$1,472/year (approx)

**Water Rates:** \$1,368/year (approx)

**Contact:** Theo Kouroulis  
0411 751 377  
Nik Zounis  
0418 913 456

**Type:** Apartment

<https://paragonproperty.com.au>

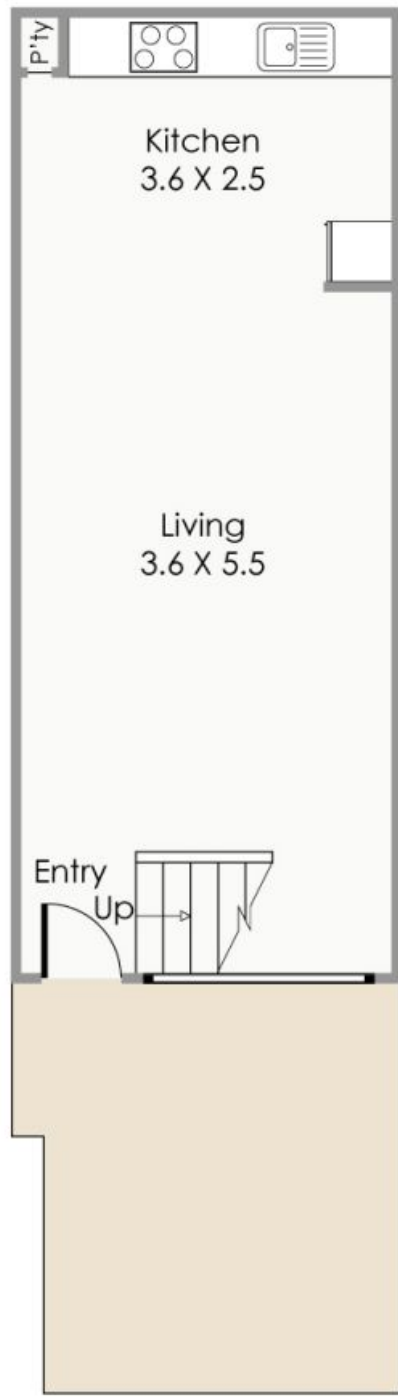

Ground Floor



First Floor

Approximate Areas

GROUND FLOOR

Residence: 33m<sup>2</sup>  
 Ext: 20m<sup>2</sup>  
 Carbay: 13m<sup>2</sup>

FIRST FLOOR

Residence: 30m<sup>2</sup>  
 Ext: 5m<sup>2</sup>  
 Total Area: 101m<sup>2</sup>

This floorplan is for illustration purposes only to show the layout of the property. Not to be used for any other purpose.



16/315 Bulwer Street, Perth

Plans shown are only indicative of layout. Dimensions are approximate.

**Perth, WA**  
 16/315 Bulwer Street