



Perth, WA
2/252 Fitzgerald Street

3 BED
2 BATH
2 CAR



VA-VA-VOOM!

Feel on top of the world in this luxuriously appointed glamour apartment. One of only two in the building, located on the top floor facing east with sweeping sumptuous views to be enjoyed overlooking Robinson Park tennis centre and the bright lights of the city skyline. You will find this, three bedroom, two bathroom abode a unique and rare opportunity to live and play on the cities doorstep while relishing the opulence offered by this huge 178sqm penthouse apartment.

\$995,000

Contact: Theo Kouroulis
0411751377
Nik Zounis
0418913456

Type: Apartment
Land: 175m2

<https://paragonproperty.com.au>

As you enter you will immediately be impressed by the contemporary style and flair of the finish and layout, the extra wow factors include natural Travertine stone flooring throughout, high ceilings, floor to ceiling glass, purpose built study area/second living, reverse cycle air conditioning and an open plan abundance of space that surrounds you, PLUS the added bonus of a two car garage.

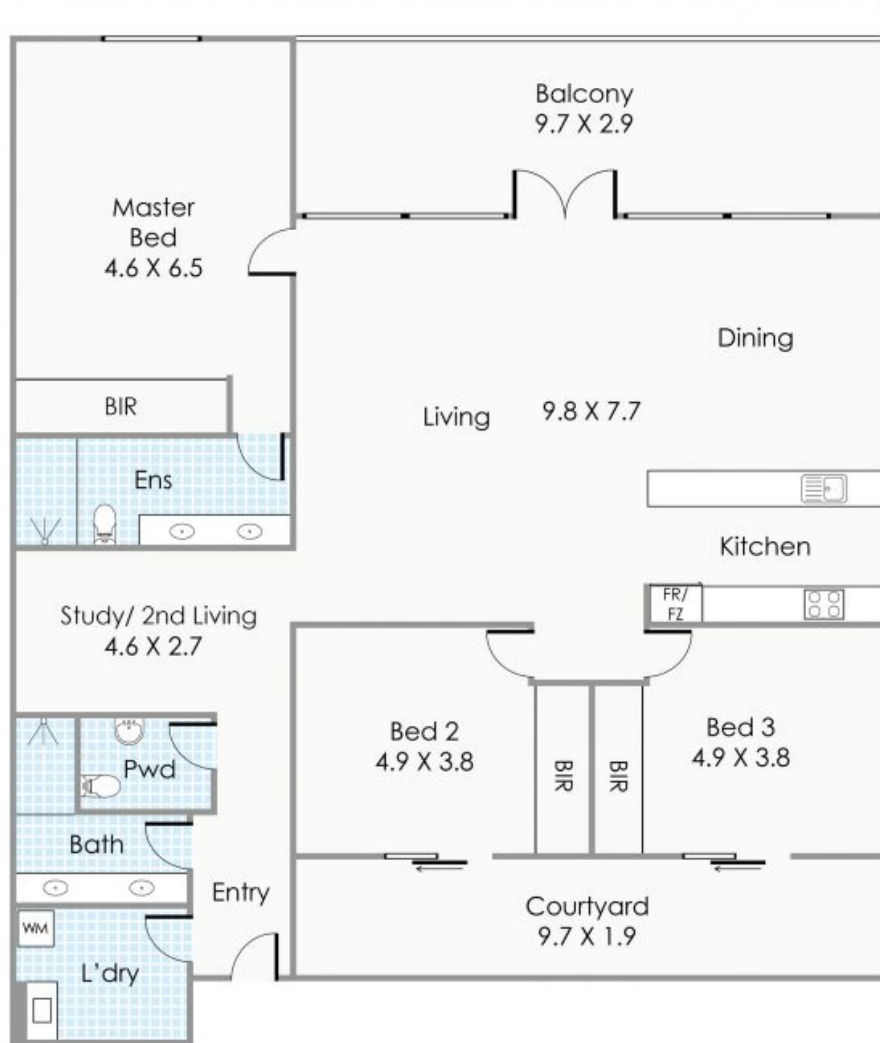

Approximate Areas

Residence:	178m ²
Courtyard:	19m ²
Balcony:	30m ²
Total Area:	227m ²

This floorplan is for illustration purposes only to show the layout of the property. Whilst every effort has been made to ensure the accuracy of this floor plan, of measurements, and any other information shown are an approximate interpretation only. Measurements and total areas do not include or account for wall thickness or roof area under eaves. Crib Creative will not be held liable or responsible for any error, omission, misrepresentation or use of any information shown on the final floor plan. Not to be used for any other purpose.
www.cribcreative.com.au



2/252 Fitzgerald Street, North Perth



Plans shown are only indicative of layout. Dimensions are approximate.

Perth, WA
 2/252 Fitzgerald Street