



Mount Lawley, WA
103 Chelmsford Road

3
BED

1
BATH

4
CAR

paragon
PROPERTY

CHARACTER ON CHELMSFORD

Available for the first time in nearly 70 years, this family home is situated on a great sized 463m² block. Located on the sought after Chelmsford Road, sitting in prime position between Hyde Park and the Mount Lawley and North Perth café strips. This C.1911 build is full of gorgeous character features with stunning fireplaces, soaring decorative ceilings and original jarrah floorboards underneath the retro carpets.

The property has so much potential to create your dream home. Zoned R40 with Right Of Way access presents the possibility of subdivision development.

The large formal lounge and one of the two generous sized bedrooms located off the main hallway contain some of the most amazing and unique fireplaces you will ever see. There is another good sized bedroom towards the back of the property, just off from the kitchen and dining area. This flows out onto the sleep-out containing the bathroom and a separate

study or fourth bedroom. All backing onto the large garden with separate laundry and multiple garages/sheds with ROW access.

If you are looking for character charm with

SOLD

Council Rates: \$1,703/year (approx)

Contact: Theo Kouroulis
0411751377
Nik Zounis
0418913456

Type: House

Sold Date: 31/12/2021

Land: 463m²

<https://paragonproperty.com.au>

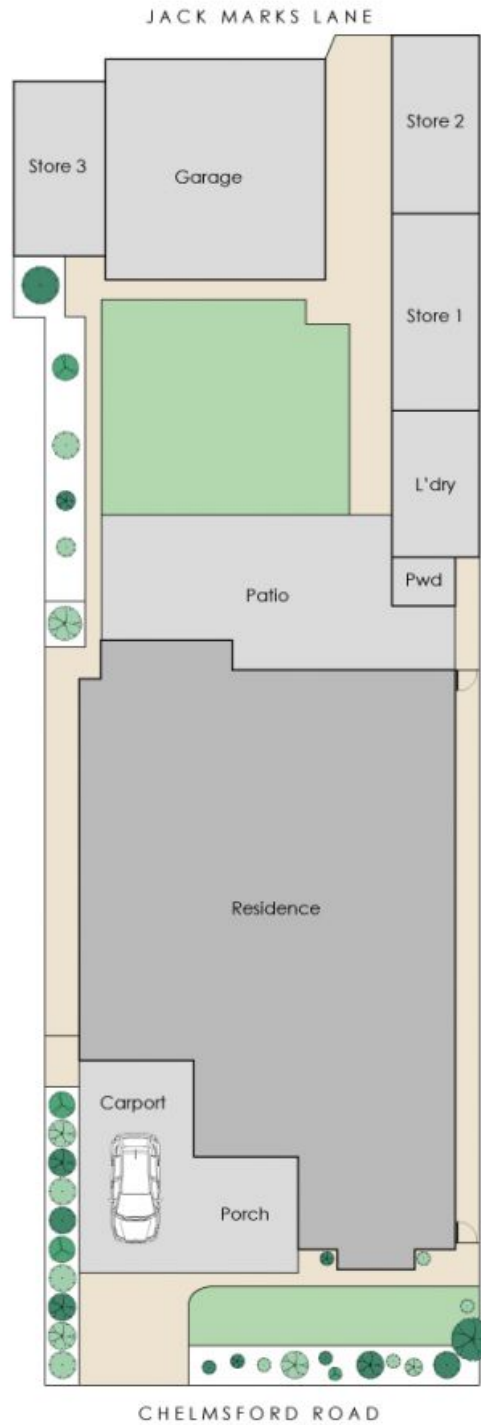

Approximate Areas

Residence:	140m ²
Patio:	30m ²
Garage:	32m ²
Carport:	16m ²
Store 1:	11m ²
Store 2:	10m ²
Store 3:	10m ²
Porch:	8m ²
Total Area:	257m²

This floorplan is for illustration purposes only to show the layout of the property. Whilst every effort has been made to ensure the accuracy of this floor plan, all measurements, and any other information shown are an approximate interpretation only. Measurements and total areas do not include or account for wall thickness or roof area under eaves. CIB Creative will not be held liable or responsible for any error, omission, misrepresentation or use of any information shown on the final floor plan. Not to be used for any other purpose.
www.cibcreative.com.au



103 Chelmsford Road, Mount Lawley



Plans shown are only indicative of layout. Dimensions are approximate.

Mount Lawley, WA
103 Chelmsford Road